

Courtesy of: DiscountCarStereo.com  
Serving the internet community since 1995



## **A2D-JAG97**

### **QUICK START MUSIC STREAMING INSTALLATION GUIDE FOR SELECT 1986-97 JAGUAR**

Created February 6, 2017  
Revised: December 30, 2022

## PRODUCT SAFETY & DISCLAIMER

READ ALL INSTRUCTIONS CAREFULLY BEFORE INSTALLING, FAILURE TO DO SO MAY CAUSE PERSONAL INJURY OR DAMAGE TO PRODUCT AND/OR PROPERTY

- This installation guide is provided as a GENERAL installation guide, some vehicles vary and may require additional steps. We do not accept responsibility for third party labor charges or modifications. Exercise due-diligence when installing this product.
- We do not accept any responsibility for vehicle damage or personal injury resulting from the installation of this product.
- Careless installation and operation can result in equipment damage.

## Requirements

Radio with TAPE/CD button on faceplate and 8-pin port

## Introduction

**10/21 Update: Module for vehicles with CD changer supports Bluetooth 5.0 and Bluetooth 4.2 remain for vehicles without CD changer.**

**12/28/21 Update: Installation 3 has changed allowing customers to install module at CD changer socket in trunk/hatch or at the radio (your choice)**

Portable audio products are everywhere, reflecting demand from active people all over the world to take their music on the road. The A2D-JAG97 provides **Bluetooth music streaming** solution from any A2DP device to allow Jaguar owners to stream audio books, Apple music, turn by turn directions and more directly into audio system via the CD changer port. The A2D-JAG97 is compatible with Jaguar CD changer controlling radios with or without optional CD changer. Vehicles with optional CD changer have the option to retain or disconnect it.

**Dependent on vehicle options, this module may be installed at the radio or to the CD socket in trunk/hatch. See installation 1, 2 & 3.**

See **Frequently Asked question** at the end of this guide for more details.

## Installation 1: at the radio (vehicles without CD changer)

Vehicles without CD changer may opt to install module at the radio or to CD changer socket in trunk/hatch- **CD changer must be disconnected and will no longer function.**

**Warning:** Installation 1 applies to vehicles without CD changer or if CD changer is disconnected or malfunctions. If you would rather not remove radio and vehicle is pre-wired to trunk or hatch (See Fig. 3); you may opt to connect module there instead. (See installation 2 on page 3.)

Click [here](#) to remove radio or click link below for dash removal instruction video. XK models differ slightly. <https://www.youtube.com/watch?v=vpAldr6V3iE>

1. Disconnect CD plug (if present) from radio "CD" socket (See Fig.2)
2. Connect module 8-pin plug (See Fig. 1) to radio "CD" input socket (See Fig. 2)



Fig. 1

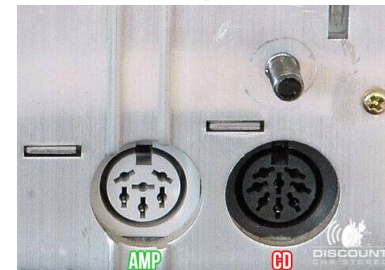

Fig. 2

2. Re-assemble dashboard and proceed to "Pairing" on page 4

## Installation 2: To trunk/hatch (vehicles without CD changer)

**Warning:** Installation 2 applies to vehicles pre-wired to trunk/hatch (See Fig. 3) without CD or CD no longer wanted, malfunction or disconnected. If retaining CD changer; go to installation 3



Fig. 3

1. Disconnect CD changer (if present) from factory 8-pin socket (See Fig. 3)
2. Connect module 8-pin plug (See Fig. 1) to factory 8-pin socket in hatch or trunk (See Fig. 3). CD changer (if present) must be disconnected and will no longer function.
3. Proceed to "Pairing" on page 4

## Installation 3: With CD changer (retaining CD changer)

This module has been revised to allow customers to install module at the radio or to CD socket in trunk or hatch—your choice!

**Warning:** Installation 3 applies to retaining a functioning CD changer. If not retaining CD changer or if vehicle does not have one; GO to installation 1 or 2 above.

### Installing module to CD socket in trunk:

1. Disconnect CD changer plug from factory 8-pin socket (See Fig. 3)
2. Connect CD changer plug (See Fig. 1) to module 8-pin socket (See Fig. 4)



Fig. 4

3. Connect module 8-pin plug (See Fig. 1) to CD socket (See Fig. 3)
4. Connect/splice or tap red wire (See Fig. 5) to vehicles 12V accessory (switched) supply.  
12V accessory may be available in rear fuse box. **Use voltmeter to test light to verify voltage condition prior to finalizing install.**

**Do not connect accessory wire to 12V battery (always on)**



Fig. 5

5. Proceed to "Pairing"

## Installing module to radio CD socket:

Click [here](#) to remove radio or click link below for dash removal instruction video. XK models differ slightly. <https://www.youtube.com/watch?v=vpAldr6V3iE>

1. Disconnect CD changer plug (See Fig. 1) from radio socket (See Fig. 2)
2. Connect CD changer plug (See Fig. 1) to module 8-pin socket (See Fig. 4)
3. Connect module 8-pin plug (See Fig. 1) to CD socket (See Fig. 2)
4. Connect/splice or tap red wire (See Fig. 5) to vehicles 12V accessory (switched) supply.  
12V accessory is available on radio power harness (usually Green/Orange, purple, red/white etc. **Use a voltmeter or test light to verify voltage condition prior to finalizing install.**

**Do not connect module red wire to 12V battery (always on).**



Fig. 5

5. Proceed to pairing

## Pairing

Pairing process varies among devices but basic steps are the same. This process is done upon initial install and will not have to be repeated.

1. Turn ignition and radio "ON"  
*LED inside module peephole will flash (pairing mode)*
2. Go to device: **Settings, Wireless & Networks, Bluetooth Settings**
3. Select **Bluetooth** and turn it "ON" (if not already ON).
4. Tap **Scan for devices**.
5. Wait for Bluetooth device name to appear (See below) and tap.  
*LED inside module peephole glow steady.*

Bluetooth



Now discoverable as "King Solomon's iPhone".

MY DEVICES

DisCarSt

Connected ⓘ

OR

Bluetooth



Now discoverable as "King Solomon's iPhone".

MY DEVICES

SKY International

Connected ⓘ

*Note: It is possible to pair multiple devices, but only one connection is supported. Pairs automatically with device to which it was most recently connected.*

## Optional remote control

Purchase optional Bluetooth wireless remote to control music apps on the road or at home.

Optional remote control allows users to:

1. Keep audio device in pocket, glovebox, purse or elsewhere
2. To track up/down within playlist etc.
3. To adjust audio device volume (up/down)

### Pairing:

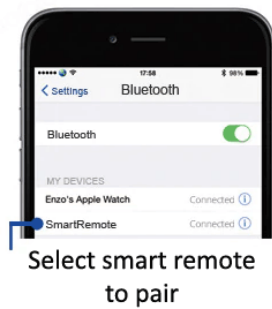

### Remote control operation:

Use wireless remote to perform the following functions on any iOS7.0 and higher or Android 4.4 and higher.

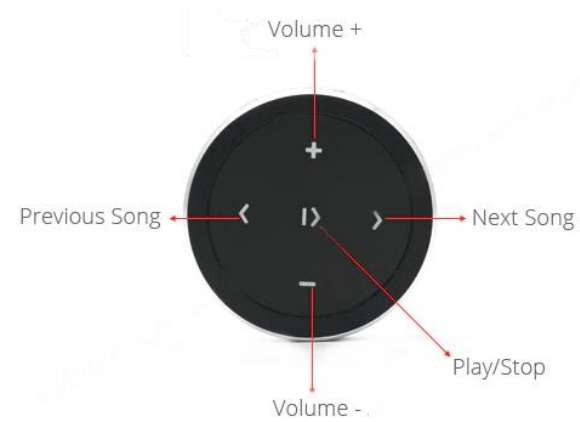

### Package contents:

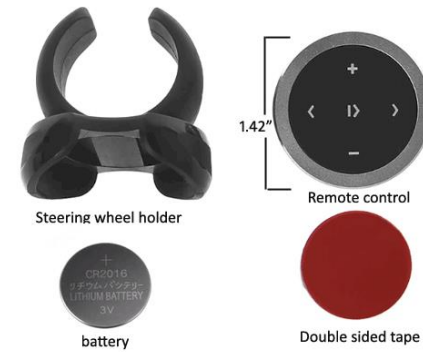

## Bluetooth operation

1. Turn ignition and radio "ON"
2. If retaining CD changer playback, at least one disc must remain in changer magazine
3. Press "CD" button on radio.
3. Launch streaming application on audio device
4. Use radio volume control button to set the playback level. If distorted, lower volume on audio device or if inaudible, raise volume on audio device.

**Warning:** Playlist and track selection \*NOT\* possible from radio buttons. Use smart device built-in controls and display to access and control audio files and applications.

## CD playback: Retaining CD changer

- a. Press "CD" button on radio  
(At least one disc must be loaded to changer magazine)
- b. **Disable Bluetooth** on smart device. CD plays on car speaker.  
- Control CD from radio buttons as customary.

### To resume streaming:

**Re-enable Bluetooth** in smart device settings screen. Wait a few seconds for device to pair

*Note: Streaming has priority and remains until disabled. CD changer playback is only possible if module is no longer paired or smart device is out of range.*

5. If correct operation is confirmed, tuck away any extra wires and enjoy!

## Frequent ask questions & troubleshooting

1. My vehicle has a functioning CD changer. Can I keep it and also be able to stream from smartphone?  
**YES;** if CD changer in trunk or hatch is **functional**, the A2D-JAG97 is able to provide a streaming solution without disrupting **CD changer functionality**.
2. I notice both your A2D-JAG97 and A2D-JAG98 list compatibility with 1997 XK. What's the difference and which should I purchase?  
Jaguar introduced an updated audio system in late 1997 XK8 which means vehicles in the same calendar year will have different audio systems (connectors/plugs). If you own a late 1997 XK8, please inspect the CD terminal for the two possibilities:  
**Fig. 6.** Ai-NET (right) applies to late 1997 XK8 and fits our [A2D-JAG98](#)  
Older vehicles including early 1997 XK8 with 8-pin DIN plug (left) fits out our [A2D-JAG97](#)

**Avoid costly returns by inspecting your vehicle prior to ordering**



Fig. 6

8-pin DIN (left) applies to early 1997 XK8

3. **I purchased option to retain CD changer playback, but how do I switch between streaming and changer playback?**  
The module automatically switches to CD if not paired to smart device. To resume streaming simply re-enable Bluetooth. **At least one disc must remain in changer magazine otherwise switching may not complete.**
4. **Why do I pay more for not having or retaining CD changer?**  
In the absence of a changer, the radio "CD" button has no function. In order to activate the CD button, an additional circuit board is required. The additional circuit board allows radio to switch into "CD" (Bluetooth) mode.
5. **Can I connect the A2D-JAG97 module directly to the radio?**  
**YES;** Users have the option to connect all version of this module at the radio or at the CD socket in trunk/hatch—your choice
6. **Can I control smartphone playback from radio buttons?**  
**NO;** you must use smart device built-in controls to access music files. Radio volume control is used to set playback level. A safer option is to purchase optional [remote control](#) which includes most used functions (e.g., track up/down, pause etc.) and helps to keep eyes on the road.
7. **I've connected module, but phone does not find device to pair.**  
For installation options 3, red accessory wire must be connected to a 12V power supply source otherwise device will not pair. Follow installation 3 on page 3.

#### **Disclaimer**

- This product has no affiliation with Jaguar
- We're not liable for misuse of this product.
- Whenever possible professional installation is recommended.

For additional questions email [support@discountcarstereo.com](mailto:support@discountcarstereo.com)

© 1995- Dec-22 Discount Car Stereo. All rights reserved. Information in this document is subject to change without notice. Other products and companies referred to herein are trademarks or registered trademarks of their respective companies or mark holders.