

Courtesy of: DiscountCarStereo.com
Serving the internet community since 1995



CTSx-HAR

XM RETROFIT INSTALL GUIDE FOR CADILLAC CTS & SRX

Created August 10, 2015
Revised: September 13, 2022

PRODUCT SAFETY & DISCLAIMER

READ ALL INSTRUCTIONS CAREFULLY BEFORE INSTALLING, FAILURE TO DO SO MAY CAUSE PERSONAL INJURY OR DAMAGE TO PRODUCT AND/OR PROPERTY

- This installation guide is provided as a GENERAL installation guide; some vehicles vary and may require additional steps. We do not accept responsibility for third party labor charges or modifications. Exercise due-diligence when installing this product.
- We do not accept any responsibility for vehicle damage or personal injury resulting from the installation of this product.
- Careless installation and operation can result in equipment damage.

Requirements:

FACTORY RADIO, XM ANTENNA, XM TUNER

Introduction:

Many Cadillac SRX and CTS were not outfitted with XM and the CTSx-HAR harness allows user to retrofit XM in 1st Generation CTS (All radios) and SRX (non-navigation radio only).

This harness provides XM tuner (Sold separately) with Power, audio and data.

User must ensure XM tuner and XM antenna are in working order.

SRX with navigation requires our [SRXL-HAR](#)

Installation: To radio

Radio must be removed to gain access to plugs.

(SRX & XLR with Navigation requires our [SRXL-HAR](#))

1. Using a panel removal tool, unclip and remove the top A/C vents panel (See Fig. 1)

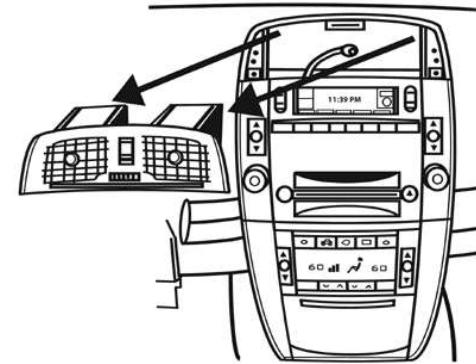

Fig. 1

2. Open ash tray and remove tray. Extract (1) 9/32" (7mm) screw in tray cavity.
3. Using a panel removal tool, unclip and remove A/C Control/ash tray assembly below radio (See Fig. 2)

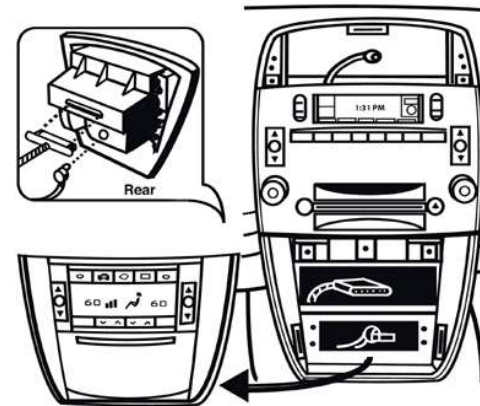

Fig. 2

4. Remove (4) 10mm bolts securing radio to dash (See Fig. 3)

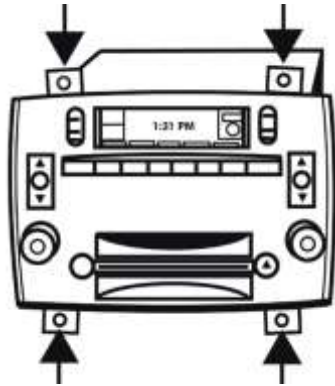

Fig. 3

5. Pull radio forward to reveal and gain access to the connectors (See **Fig. 4**)



Fig. 4

Factory gray plug

6. Press release tab to disconnect 8-pin **gray plug** from radio (See **Fig. 4**)
7. Connect gray plug to installation harness 8-pin connector (See **Fig. 5**).



Fig. 5

8-pin connector

8. Connect installation harness 8-pin black plug (See **Fig. 6**) to radio chamber vacated in step 6.



Fig. 6

8-pin plug

9. If radio has 3-part socket green plug (See **Fig. 7**) splice harness wire to radio purple wire at pin 8 or 11. If for any reason the radio does not have green plug, we include a green plug which must be inserted to radio slot (middle). Inset harness blue wire to pin 8.

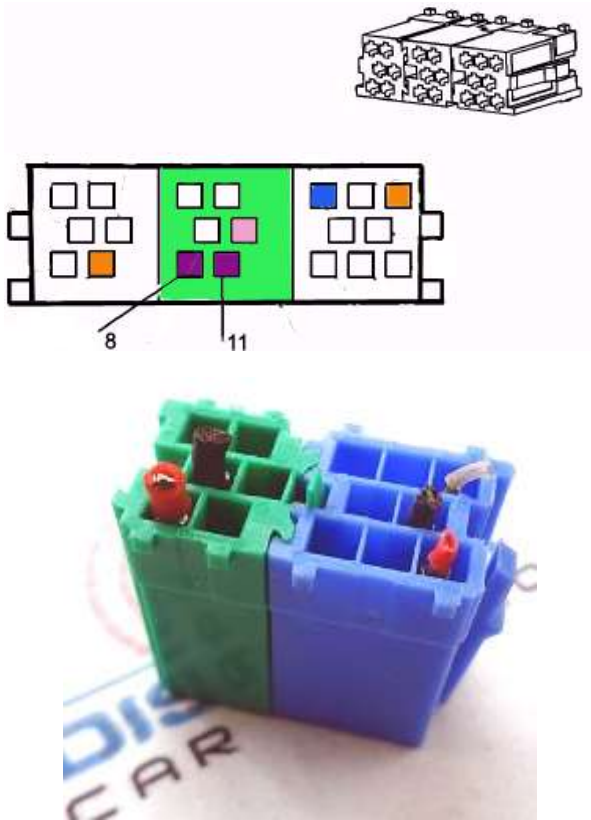

Fig. 7
Radio 20-pin socket

10. Connect harness 16-pin plug (See **Fig. 8**) to XM tuner (See **Fig. 9**)

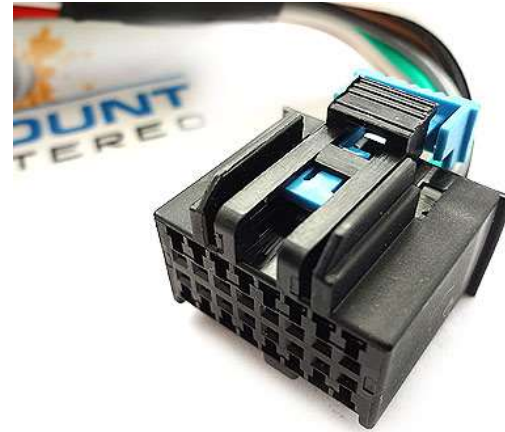

Fig. 8



Fig. 9

11. Connect antenna terminal to XM tuner
Proceed with XM tuner programming/set-up

Operation:

1. Turn Radio "ON"
2. Press "BAND" button until **XM1** or **XM2** is displayed. This confirms radio communicating with Module. Call XM or Sirius to activate tuner.

Warning! Used XM modules may require programming.

SIR-GM installation

You may also use the CTSx-HAR to install the SIR-GMI Sirius radio kit. Simply connect harness 16-pin plug (See **Fig. 8**) to SDAR harness (See **Fig. 10**) included in the SIR-GMI kit. Proceed with install instructions included in SIR-GMI kit.

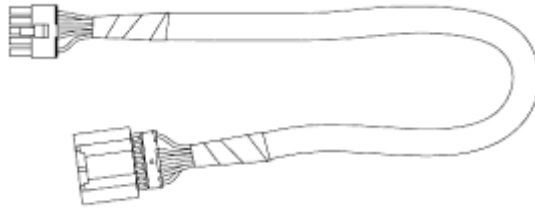

Fig. 10

Aftermarket iPod adapter Installation:

The CTSx-HAR, also allows users to install the aftermarket iPod adapter (e.g. PA15-VETTE) behind the stereo as oppose to rear deck or side panel. Simply connect harness 16-pin plug (See **Fig. 8**) to installation harness included with aftermarket iPod adapter Kit (e.g. PA15-VETTE, PA15-GM etc.), then proceed with install instructions included in iPod adapter kit.

Frequently asked questions:

1. **Will the CTSx-HAR work in vehicles with Navigation?**
YES; Except SRX with Navigation radios.
2. **How can I check if vehicle has XM module?**
Turn Radio "ON", press "BAND" button repeatedly to cycle through AM/FM/XM1/XM2. If only AM/FM is displayed, vehicle does not have XM Tuner Module.
3. **Can I install this harness without removing stereo?**
NO; The CTSx-HAR connects to the radio and because of that the radio must be removed.
4. **XM/iPod adapter etc. sounds only on one side. What is the fix?**
Late 2004 and early 2005-07 production CTS has the left audio and ground wires switched (compared to 2003- early 04). To fix, switch **pins 3 (Blue/white) with pin 4 (Yellow) or vice versa.**



Fig. 11

Disclaimer

- This product has no affiliation with Cadillac
- We're not liable for misuse of this product.
- We recommend professional installation

email support@discountcarstereo.com

© 1995-Sep-22 Discount Car Stereo, Inc. All rights reserved. Information in this document is subject to change without notice. Other products and companies referred to herein are trademarks or registered trademarks of their respective companies or mark holders.